

FOR LEASE

5,333 SF AVAILABLE
9701 DESSAU ROAD | PARK 10 | SUITE 602
NORTHEAST INDUSTRIAL SUBMARKET



FOR LEASE

5,333 SF AVAILABLE
9701 DESSAU ROAD | PARK 10 | SUITE 602
NORTHEAST INDUSTRIAL SUBMARKET



**5,333 SF
AVAILABLE**



FOR LEASE

5,333 SF AVAILABLE
9701 DESSAU ROAD | PARK 10 | SUITE 602
NORTHEAST INDUSTRIAL SUBMARKET



SPACE FOR LEASE - INFORMATION

- **5,333 SF AVAILABLE**
 - **20% OFFICE**
- **16' CLEAR HEIGHT**
- **100% HVAC**
- **100' BUILDING DEPTH**
- **105' TRUCK COURT DEPTH**
- **1 DOCK HIGH, 1 GRADE LEVEL DOOR**
- **DESSAU ROAD FRONTAGE**
- **3.1 PARKING SPACES PER 1,000 SF**
- **NEW TPO ROOF: 2017**

MARKETED BY:

LEIGH ELLIS

512-684-3802 (D)

512-632-7167 (M)

ELLIS@AQUILACOMMERCIAL.COM



FOR LEASE

5,333 SF AVAILABLE
9701 DESSAU ROAD | PARK 10 | SUITE 602
NORTHEAST INDUSTRIAL SUBMARKET

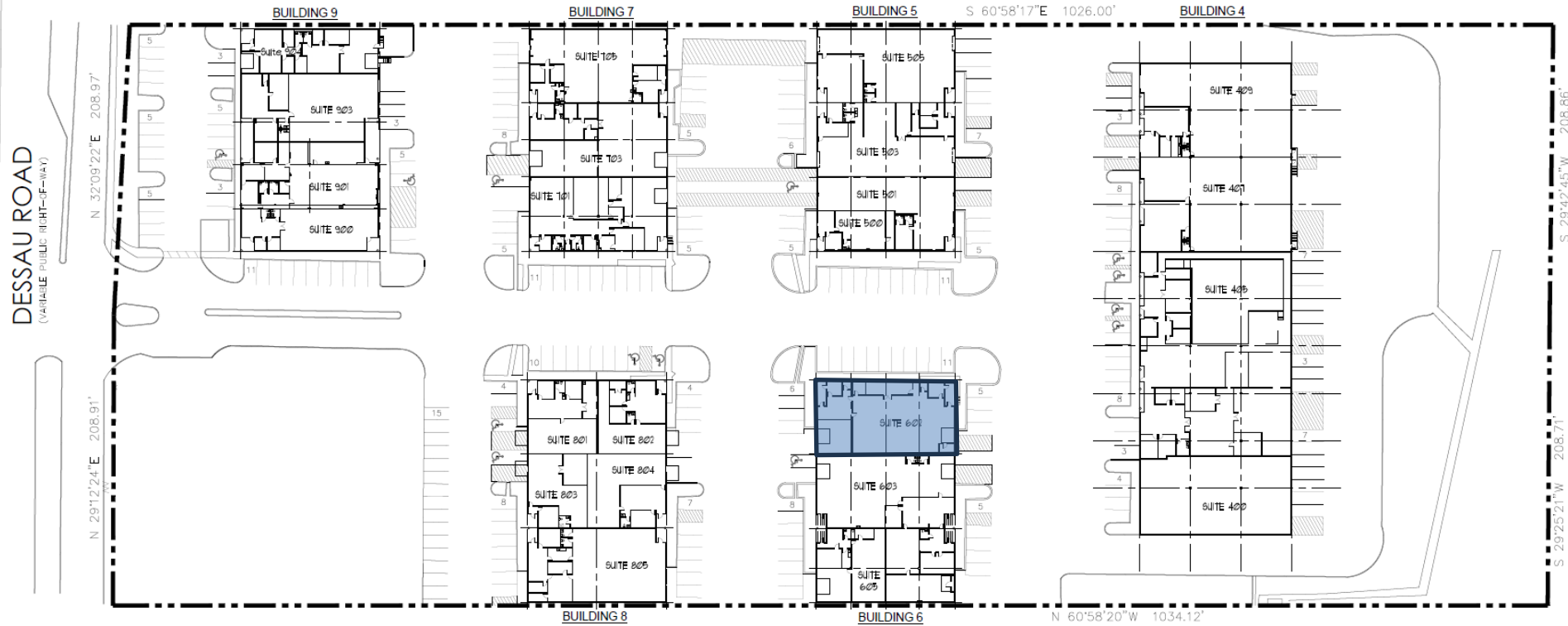

FOR LEASE

5,333 SF AVAILABLE
9701 DESSAU ROAD | PARK 10 | SUITE 602
NORTHEAST INDUSTRIAL SUBMARKET



FOR LEASE

5,333 SF AVAILABLE
9701 DESSAU ROAD | PARK 10 | SUITE 602
NORTHEAST INDUSTRIAL SUBMARKET



Downtown Austin

Dessau Road