

# FOR LEASE

3,200 SF AVAILABLE  
9701 DESSAU ROAD | PARK 10 | SUITE 904  
NORTHEAST INDUSTRIAL SUBMARKET





# FOR LEASE

**3,200 SF AVAILABLE**  
**9701 DESSAU ROAD | PARK 10 | SUITE 904**  
**NORTHEAST INDUSTRIAL SUBMARKET**



**3,200 SF  
AVAILABLE**

**DESSAU ROAD**





# FOR LEASE

**3,200 SF AVAILABLE**  
**9701 DESSAU ROAD | PARK 10 | SUITE 904**  
**NORTHEAST INDUSTRIAL SUBMARKET**



## SPACE FOR LEASE - INFORMATION

- **3,200 SF AVAILABLE**
  - **25% OFFICE**
- **12' CLEAR HEIGHT**
- **100% HVAC**
- **100' BUILDING DEPTH**
- **1 DOCK HIGH DOOR**
- **DESSAU ROAD FRONTAGE**
- **0.9 MILE EAST OF I-35**
- **3.1 PARKING SPACES PER 1,000 SF**
- **NEW TPO ROOF: 2017**

## MARKETED BY:

**LEIGH ELLIS**

512-684-3802 (D)

512-632-7167 (M)

[ELLIS@AQUILACOMMERCIAL.COM](mailto:ELLIS@AQUILACOMMERCIAL.COM)



# FOR LEASE

**3,200 SF AVAILABLE**  
**9701 DESSAU ROAD | PARK 10 | SUITE 904**  
**NORTHEAST INDUSTRIAL SUBMARKET**

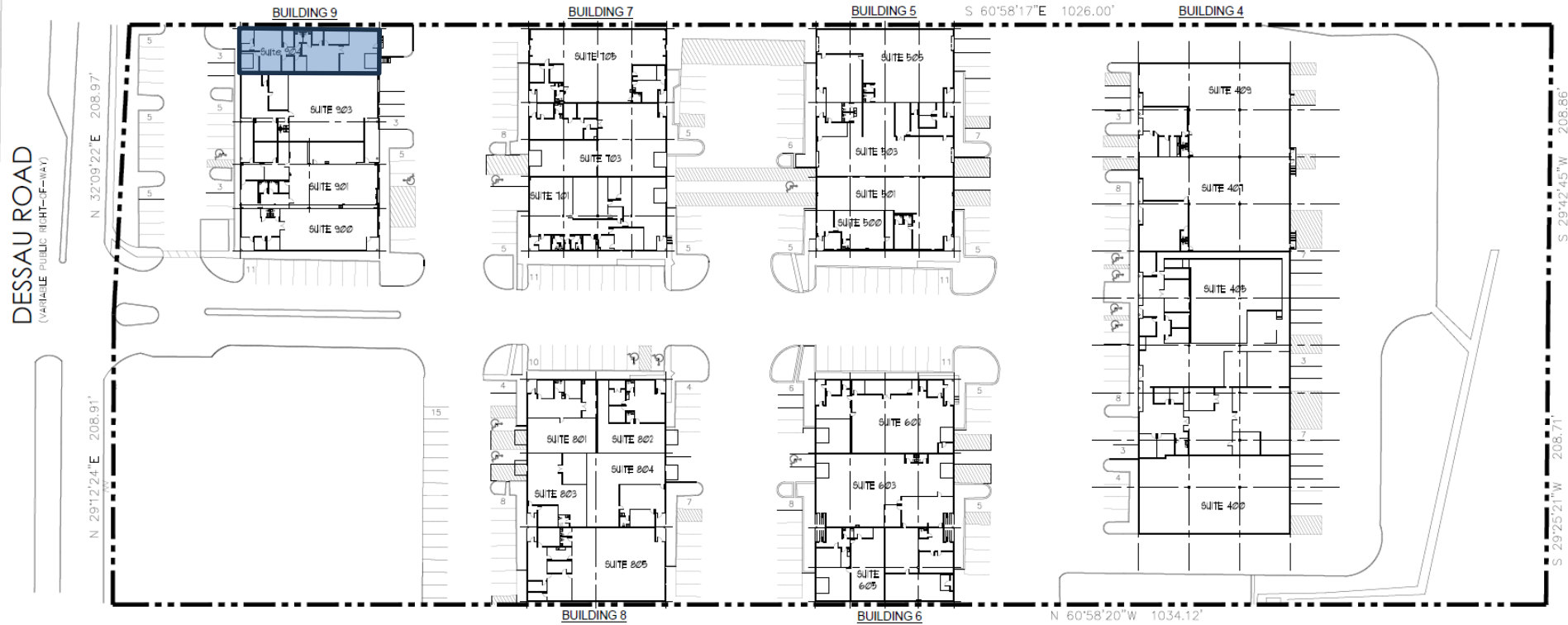



# FOR LEASE

**3,200 SF AVAILABLE**  
**9701 DESSAU ROAD | PARK 10 | SUITE 904**  
**NORTHEAST INDUSTRIAL SUBMARKET**





# FOR LEASE

3,200 SF AVAILABLE  
9701 DESSAU ROAD | PARK 10 | SUITE 904  
NORTHEAST INDUSTRIAL SUBMARKET



Downtown Austin

Dessau Road